



### AM090HBIPA

 **Black**  
Model: AM090HBIPA

 **White**  
Model: AM090HWIPA

### PRODUCT SPECIFICATIONS

Internal Capacity	0.9 cu. ft.
Cooking Wattage	900 watts
Internal Power Allocator	Prevents overloaded electrical system when microwave and refrigerator are operating on the same circuit
Power Cord	6 ft. long
Control Type	Electronic Touch Pads with Child Control Lock
Power Levels	10 Power Level Selections
LED Display	Time, Power and Indicators
Auto Cook Selections	Potato, Popcorn, Pizza, Beverage, Frozen Dinner, Reheat
Cook by Weight	Beef, Mutton, Pork or Input Weight (max 5 lbs. 16 oz.)
Defrost by Weight	Defrost up to 5 lbs. 16 oz.
Speed Defrost	Defrost Based on Time
Kitchen Timer	99 minutes and 99 seconds
Express Cook	30 seconds on High
Door Opening	Easy Push-to-Open Button
Turntable	10.63 in. Diameter Glass Turntable

### DIMENSIONS

Width	19.02 in.
Depth	14.14 in.
Height	11.06 in.
Weight	27.12 lbs.
Carton Width	21.54 in.
Carton Depth	16.14 in.
Carton Height	13.27 in.
Shipping Weight	29.76 lbs.
Shipping Cube	2.67 cu. ft.

### ELECTRICAL

The electrical requirements are a 120 V, 60 Hz, AC only, 20 A. It is recommended that a separate circuit serving only the oven be provided. The oven is equipped with a 3-prong grounding plug. It must be plugged into a wall outlet properly installed and grounded.

Power Consumption:  
120 V | 60 Hz | 1350 W (microwave)



### INSTALLATION REQUIREMENTS

1. Make sure that all the packing materials are removed from the inside of the door.
2. This microwave oven must be placed on a flat.
3. For correct operation, the oven must have sufficient air flow. Allow 20 cm of space above the oven, 10 cm at back and 5cm at both sides. Do not cover or block any openings on the appliance. Do not remove feet on which oven stands.
4. Do not operate the oven without glass tray, roller support, and shaft in their proper positions.
5. Make sure that the power cord is undamaged and does not run under the oven or over any hot or sharp surface.
6. The socket must be readily accessible so the microwave oven can be easily unplugged in an emergency.



Internal Power Allocator Outlet

Microwave Cord to Wall Outlet

Refrigerator Cord to IPA Outlet

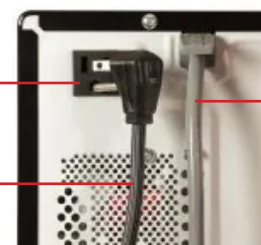

(Back of Microwave)