

Cook 'N Cool® Microwave/Refrigerator/Freezer

With Internal Power Allocator Microwave

10.3 cu. ft. TopFreezer - Frost-Free



CC1031F

Factory-Assembled

☒ **Black:** CC1031FB-IPA

☐ **White:** CC1031FW-IPA

Knock-Down Version

☒ **Black:** CC1031FBKD-IPA

☐ **White:** CC1031FWKD-IPA



Refrigerator/Freezer Only
(ARD1033F*14R/L)
*W-white, B-black, S-stainless

REFRIGERATOR FEATURES

Energy	ENERGY STAR® Qualified - Tier I 297 KWH/Yr Energy Consumption 10% less energy than Federal Standard
Defrost Type	Frost-Free
Refrigerant Type	Non-Flammable R134A
Foaming Agent Type	Non-Flammabel 245F
Temperature Control	Full Range Control
Door Type	Easy-Clean Euro-Round Doors
Door Handles	Integrated Handles
Door-Swing	Reversible (Factory Standard, Right-Hand Hinge)
Interior Lighting	Automatic Refrigerator Light
Crisper	1 Full-Width See-Thru Crisper
Interior Shelves	2 Full-Width Adjustable Wire Shelves 1 Full-Width Glass Crisper Cover
Refrigerator Door Storage	4 Full-Width Shelves Lower Shelf accepts 2-Liter Bottles
Freezer Interior	1 Full-Width Shelf
Freezer Door Storage	2 Full-Width Shelves
Leveling	2 Front Adjustable Leveling Feet
Capacity	10.3 cu. ft. Total Capacity 7.9 cu. ft. Refrigerator 2.4 cu. ft. Freezer

MICROWAVE FEATURES with Internal Power Allocator

Capacity/Cooking Watts	0.9 cu. ft. / 900 watts
Control Type	Electronic Touch Pads
Turntable	11" Diameter Glass Turntable

INSTALLATION REQUIREMENTS

Remove all packing material and tape. Install on a level floor or well-supported counter. Avoid any direct sunlight, heat source, or moisture. This product is designed to be *freestanding* and must be installed at least 2" from the wall, and the cabinet bottom is at least 3/4" to 1" above the floor or carpet, in order to let the air circulate freely around the unit.

IPA - INTERNAL POWER ALLOCATOR

Microwave with IPA Technology prevents overloaded electrical system when the microwave and refrigerator/freezer are operating on the same circuit.
Max operating amperage at 100% power: 11.3 Amps

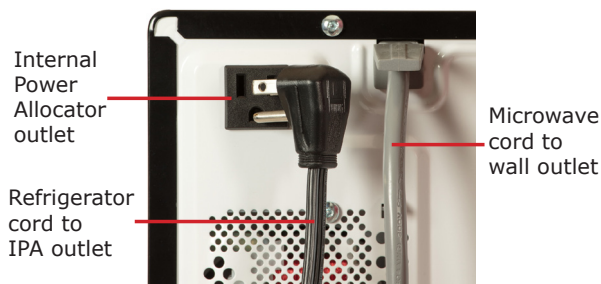

ELECTRICAL

A minimum 15 AMP electrical supply is required (20 AMP electrical supply preferred). A time-delay fuse or circuit breaker and separate circuit is recommended.
115V., 60 Hz.

Refrigerator Operating Amps:1.6A

Cook 'N Cool® - Maximum Operating Amps:11.3A

Single 6 ft. power cord-to-outlet

DIMENSIONS & WEIGHTS

	Product	Carton/Shipping
Height (inches)	69 1/2	70 3/4
Width (inches)	23 5/8	24 1/4
Depth (inches)	26 3/4	28 1/2
Weight (lbs)	154	172
Shipping Cube (cu. ft.)	-	28.1



Product specifications subject to change without notice.

Absocold, P.O. Box 1545, Richmond, IN 47375 Toll-Free: 800-843-3714 • Fax: 765-935-3450
www.absocold.com • absocold@absocold.com

© Absocold 2018

PS-CC1031F-818