

## Limited Warranty *Indoff*

### REFRIGERATOR: IRD160AB20R/L ONE FULL YEAR WARRANTY

Indoff guarantees to the original purchaser that this appliance will be free from defects in material and workmanship for a period of one year from the date of purchase, when the refrigerator is operated and maintained according to the instructions attached to or furnished with this product.

### FIVE FULL YEAR WARRANTY ON HERMETIC COMPRESSOR UNIT

Indoff additionally guarantees, to the original purchaser only, the hermetic motor (compressor) furnished as a part of this refrigerator for a period of five (5) years from the date of purchase, when this refrigerator is operated and maintained according to instructions attached to or furnished with this product.

During the above warranty periods, Indoff and its authorized dealers or its representatives retain the option to repair or replace the product, free of charge, if installation is within the fifty (50) states and the District of Columbia. If installation is outside the fifty (50) states, the cost of installation is borne by the purchaser, and Indoff's warranty obligations hereunder shall be limited to furnishing all replacement parts and materials, freight prepaid, to the continental United States port designated by the purchaser.

In an effort to properly administer its warranty policy, Indoff or its representatives may require a proof-of-purchase document before authorizing service or repair to the appliance under this warranty.

Warranty service information is available by simply contacting Indoff at the following number 1-800-843-3714 or by contacting the dealer from whom you purchased this product.

It shall be the responsibility of the purchaser to deliver any compact refrigerator or freezer of less than 4.0 cu. ft. in capacity to the nearest authorized service station, as designated by Indoff or its representatives, to obtain service under this warranty.

Except as provided herein, Indoff makes no other warranties, expressed or implied, including warranties of merchantability and fitness for a particular purpose. This warranty gives you specific rights, and you may also have other rights that vary from state to state.

MODEL # \_\_\_\_\_ SERIAL # \_\_\_\_\_

Indoff, Incorporated | 11816 Lackland Road | St. Louis, MO 63146

# Indoff

## REFRIGERATOR INSTRUCTION MANUAL

Model No.

**IRD160AB20R/L**

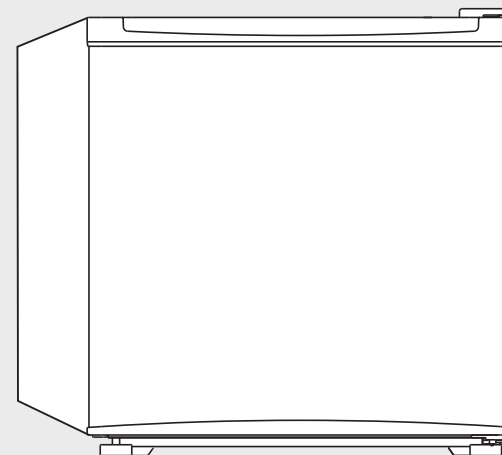



- Before using this refrigerator, please read this manual carefully.
- Always remove the drip tray while this refrigerator is running.
- Removing the drip tray will enhance the cooling power and save your electric cost.
- Blowing Agent : CYCLO-PENTANE.

Code: U124ES-04

# WARNING/SAFETY PRECAUTIONS

To avoid any risk of personal injury, material damage or incorrect use of the appliance, be sure to observe the following safety precautions. (After reading these owner's instructions, please keep them in a safe place for reference).

Remember to hand them over to any subsequent owner.

 WARNING	Indicates that a danger of death or serious injury exists
 CAUTION	Indicates that risk of personal injury or material damage exists

## WARNING

Do not plug several appliances into the same sockets.

- This could cause overheating and the risk of fire.

Keep the power plug away from the rear of the fridge.

- A damaged power plug may cause fire due to overheating.

Do not directly spray water inside or outside the fridge .

- There is a risk of fire or electric shock.

Do not bend the power cord excessively or place heavy articles on it.

- This constitutes a fire hazard. If the power cord is damaged, have it replaced immediately by the manufacturer, its service agent or a similarly qualified person.

Do not insert the power plug with wet hands.

- You may receive an electric shock.

Do not put a container filled with water on top of the appliance.

- If the water spills on to any electrical parts, it may lead to fire or electric shock.

Do not store volatile and flammable substances in the refrigerator.

- The storage of benzene, thinner, alcohol, ether, LP gas or other such substances may cause an explosion.

Do not disassemble, repair or alter the appliance.

- It may cause fire or abnormal operations, which may lead to injury.

Pull the power plug out of the socket before replacing the interior light in the refrigerator.

- Otherwise, there is a risk of electric shock.
- Only the customer service Approved Repair Agent may change the power cord and carry out any other repairs. Improper Installations and repairs may put the user at considerable risk.

Be sure to earth the appliance.

- Otherwise, it may cause material damage and electric shock.

If you wish to dispose of the fridge , throw it away after removing the door or its seals.

Keep ventilation openings in the appliance enclosure or in the built-in structure, clear of obstruction.

Do not use mechanical devices or other means to accelerate the defrosting process, other than those recommended by the manufacturer.

## CAUTION

**Do not store too much food in the appliance.**

- When you open the door, an item may fall out and cause personal injury or material damage.

**If the wall socket is loose, do not insert the power plug.**

- It may cause electric shock or fire.

**Do not disconnect the power cord by pulling on it.**

- You may disconnect a wire and cause a short circuit.

**Do not store pharmaceutical products, scientific material or other temperature-sensitive products in the refrigerator.**

- Products that require strict temperature controls must not be stored in the refrigerator.

**Do not let a child hang from the door.**

- It may cause injury or damage the appliance.

**Remove any foreign matter from the power plug pins.**

- Otherwise, there is a risk of fire.

**Do not put your hand into the bottom area of appliance.**

- Any sharp edges may cause personal injury.

**After unplugging the appliance, wait for at least five minutes before plugging it again to the wall socket.**

- It may cause abnormal operation.

**If the appliance is not be used for a long period of time, pull out the power plug.**

- Any deterioration in the insulation may cause fire.

## CAUTION

- R-600a or R-134a is used as a refrigerant. Check the compressor label or the rating label to see which refrigerant is used for your refrigerator.

When this product contains flammable gas(R-600a), please be aware of followings;

- Keep ventilation openings, in the appliance enclosure or in the built-in structure, clear of obstruction.
- Do not damage the refrigerant circuit.

And contact your local authorities in regard to the safe disposal of this product.

Ensure that none of the pipes on the back of the appliance are damaged prior to disposal.

- Do not allow children to play with this appliance.

- C-Pentane is used as an insulation blowing gas.

The flammable insulation blowing gases require special disposal procedure. Please contact your local authorities in regard to the environmentally safe disposal of this product.

- This appliance is not intended for use by persons (including children) with reduced physical, sensory or mental capabilities, or lack of experience and knowledge, unless they have been given supervision or instruction concerning use of the appliance by a person responsible for their safety.

## NAMES OF THE PARTS

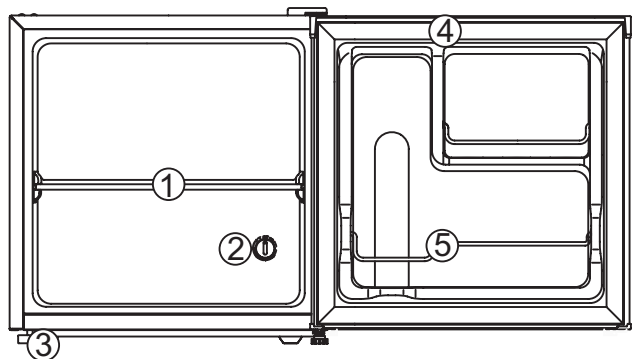

- 1 Glass Shelf
- 2 Thermostat
- 3 Adjustable front feet
- 4 Magnetic Gasket
- 5 Bottle Racks

## START

### Testing

Clean the parts of the refrigerator with lukewarm water containing a little neutral detergent and with clear water, and wipe them dry.

Notes: Electric parts of the refrigerator can only be wiped by dry cloth.

1. Remark: turn the thermostat knob to the "4" position, turn on electricity. The compressor begin to work..
2. Open the door 30 minutes later, if the temperature in the refrigerator decreased obviously, it shows that the refrigerator system works well. When the refrigerator operates for a period of time, the temperature controller will automatically set the temperature within limits it opens.

### Temperature control

- 1.The temperature in the refrigerator compartment is controlled by the temperature controller installed on the back wall of the refrigerator compartment.
- 2.Turn the thermostat knob to right or left, you can regulate the temperature inside the refrigerator.
- 3.The marks on the knob are the temperature grades, not the exact number of the degrees of temperature."OFF" shows a forced STOP and "7" shows the lowest temperature. Turn the knob from "1"position to "7"position, the temperature decreases continuously. You may set the temperature control selector to any position according to what you need.
- 4.Please set the selector to "4" position in normal use.

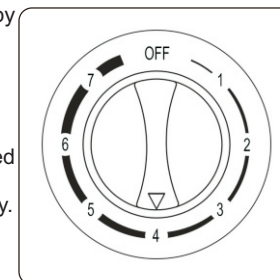

**NOTE :** Wait 3 to 5 minutes before restarting if you unplug the machine.Unit may fail to operate properly if restarted too quickly.

### How to defrost

Defrost the refrigerator when the frost accumulated on the evaporator is about 5 mm (1/5 inch) thick.

Set the thermostat dial to "OFF".Remove foods.Keep drip tray in place.Defrosting usually takes a few hours.To defrost quickly remove all foods from the refrigerator and leave door open.Never use a knife or other metal instrument to remove ice/frost from the evaporator.

After defrosting empty water from drip tray,return the thermostat dial to the desired position to start refrigerating again.

## HOW TO CLEAN

**Cleaners:** The cleaners noted below are available.

Never use harsh, abrasive cleaners, heavy-duty cleaners, or solvents on any surface.

**Exterior:** Wipe with damp, sudsy cloth, rinse and dry.

For stubborn stains and for periodic waxing, use silicon wax.

**Evaporator:** When refrigerator needs defrosting turn thermostat dial to "OFF".

Do not use sharp instruments.

**Refrigeration Section:** Wash shelves and other removable parts in warm sudsy water, rinse and dry.

Wash interior with baking soda solution (3 table spoons to one quart of water) or warm sudsy water, rinse and dry.

**Magnetic Door Seals:** Wash with warm sudsy water.

**The Finishing Touch:** Replace all parts and return thermostat dial to desired setting.

## HOW TO INSTALL

- Install refrigerator in a convenient location away from extreme heat and cold. Allow sufficient clearance between the refrigerator and side wall so the door will open for a fully usable interior.
- Select a place with strong level floor.
- Allow 2 inches of space between the refrigerator's side and the wall.

## HOW TO LEVEL

If the front of the appliance is slightly higher than the rear, the door can be opened and closed more easily.

### 1. The appliance tilts up to the left.

Turn the left adjusting leg in the direction of the arrow until the appliance is level.

### 2. The appliance tilts down to the right.

Turn the right adjusting leg in the direction of the arrow until the appliance is level.

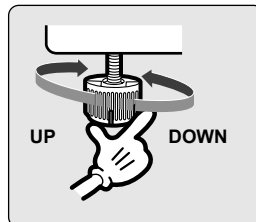

## WHAT TO DO...

### 1. When out of operating for a long time:

- Remove the power supply cord.
- Dry your refrigerator opening the door for 2-3 days.

### 2. When you get ready to move:

- Securely fasten removable interior parts (or move and package them separately)
- Do not lay your refrigerator horizontally, or compressor may be damaged.

**When you need service: Before you call for service make sure you need it, check a few things noted below for yourself first.**

### If refrigerator is not operating:

- Is the power supply cord unplugged?
- Is home fuse blown or circuit breaker off?

### If refrigerator is warmer than usual:

- Has the door been open frequently or for a long period?
- Is refrigerator overcrowded-preventing good air circulation?
- Is the hot thing stored without cooling?
- Is the clearance between refrigerator's side and the wall allowed sufficiently?

### If there are unusual sounds:

- Is refrigerator placed on the level?
- Are foreign objects behind the refrigerator?
- Are dishes on refrigerator shelves vibrating?  
If so, rearrange the dishes.

If the supply cord is damaged, it must be replaced by the manufacturer or its service agent or a similarly qualified person in order to avoid a hazard.

## DIMENSIONES

Storage	1.6 cu.ft
weight	Product:30.8 lb / Packing:35.2 lb
Size (W X D X H)	18.50(W)×17.59(D)×19.52(H) in.

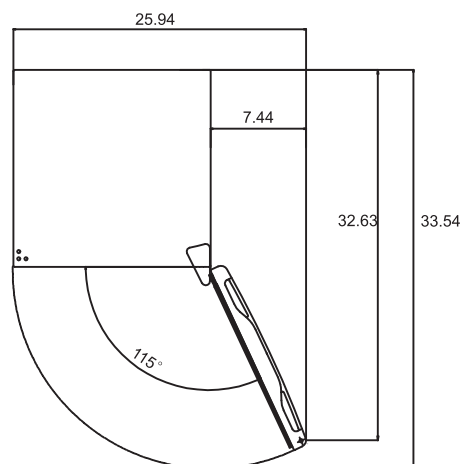
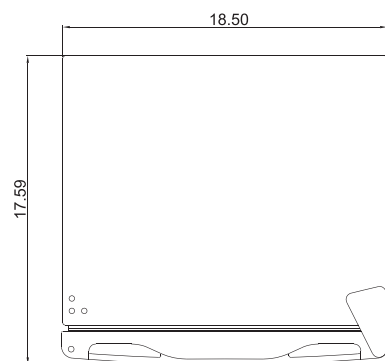
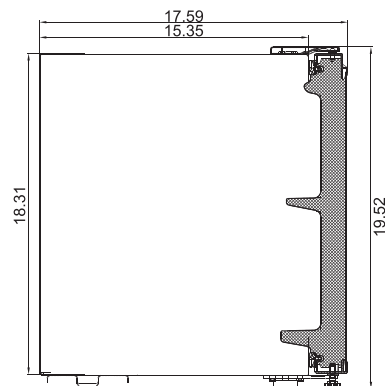
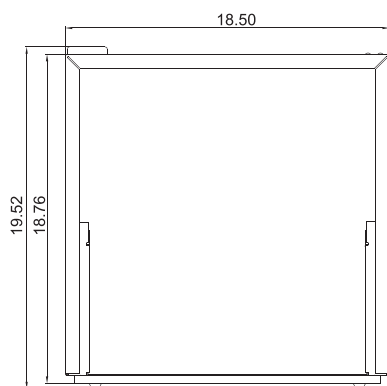

## Ambient Room Temperature Limits

This appliance is designed to operate in ambient temperature specified by its temperature class marked on the rating plate.

Temperature Class	Symbol	Range of Ambient Temperature F
Extended Temperate	SN	+50 to +89.6
Temperate	N	+60.8 to +89.6
Subtropical	ST	+60.8 to +100.4
Tropical	T	+60.8 to +109.4

**NOTE :** The internal temperature may be affected by such factors as the location of the appliance, ambient temperature and the frequency with which you open the doors. Adjust the temperature as required to compensate for these factors.

Put the newly introduced food inside.

Most power failures that are corrected in an hour and two will not affect your refrigerator temperatures. However, you should minimize the number of door openings while the power is off. But should the power failure last more than 24hours, remove all frozen food.

When you plan not to operate(during average length vacations), remove all food, disconnect the power cord, clean the interior thoroughly, and leave each door OPEN to prevent door formation.

Option: The keys are kept out of the reach of children and not in the vicinity of the refrigerating appliance, in order to prevent children from being locked inside

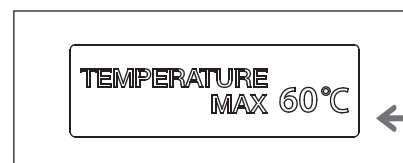

Do not put anything over 60 °C (140F) on the top of refrigerator.